

The MTN/7100 is a special purpose, side entry, low frequency accelerometer with output response starting at DC 0Hz. Made from compact stainless steel throughout for continuous vibration monitoring. Ideal for laboratory and light industrial environments. Sealed to IP65 and includes integral stainless steel overbraided cable. Alternative mountings available; four point, stud and Quickfit.

MTN/7100

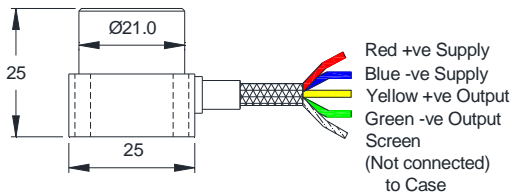

Dimensions



Applications

- Research & development
- Structural monitoring

Technical

Sensitivity 0.6-20mV/g (depending on range)
 Calibration Data supplied with sensor

Supply voltage range 5V DC

Frequency response Depending on Dynamic range ($\pm 5\%$)
 $\pm 1g$ DC to 250 Hz, $\pm 10g$ -DC to 500Hz
 $\pm 2g$ DC to 250 Hz, $\pm 20g$ -DC to 700Hz
 $\pm 5g$ DC to 300 Hz, $\pm 50g$ -Dc to 1Kz

Resonant frequency $\pm 1g$ - 700 Hz, $\pm 10g$ - 850 Hz
 $\pm 2g$ - 700 Hz, $\pm 20g$ - 1200 Hz
 $\pm 5g$ - 800 Hz, $\pm 50g$ - 1800 Hz

Isolation Base isolated

Operating temperature -20°C to $+90^{\circ}\text{C}$

Storage Temp -40°C to 125°C

Output Impedance 3000 Ohms

Acceleration Limits $\times 20$ any direction

Electrical Noise $10\mu\text{g}$

Weight 40g (nominal)

Case material Stainless steel

Cable Stainless steel over braided PVC

Sealing IP65

Studs and grub screws



Part #	From	To
MS036	¼"-28 UNF Male	M6 Male
MS039	¼"-28 UNF Male	10-32 UNF Male
MS067	¼"-28 UNF Male	M8 Male
MS068	¼"-28 UNF Male	¼"-28 UNF Male
MS124	¼"-28 UNF Male	M10 Male
MS132	¼"-28 UNF Male	M12 Male

Quick fit adapters

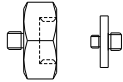

Part #	From	To
MS001	Q/F Male	Glue base
MS002	Q/F Male	M8 Male
MS003	Q/F Male	M10 Male
MS004	Q/F Male	¼"-28 UNF Male
MS006	Q/F Male	M6 Male

Optional sensors

ORDER CODE PART No	MOUNTING	
MTN/7100	SMALL FOUR POINT	REQUIRES
MTN/7110	LARGE FOUR POINT	4 x M3 BOLTS
MTN/7120	¼" UNF SINGLE POINT	SEE ABOVE FOR BASE AND ADAPTERS
MTN/7120F	10-32UNF SINGLE POINT	
MTN/7120Q	QUICK FIT SINGLE POINT	

Mounting adapters

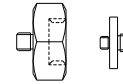

Part #	From	To
MS005	Q/F Male	¼"-28 UNF Female
MS007	Q/F Male	10-32 UNF Female
MS008	Q/F Male	M8 Female
MS011	¼"-28 UNF Male	Q/F Female
MS013	¼"-28 UNF Male	Glue base
MS033	¼"-28 UNF Male	Q/F Female
MS038	Q/F Male	M8 Conical Male
MS061	¼"-28 UNF Male	10-32 UNF Male
MS079	¼"-28 UNF Male	Q/F Female
MS106	Q/F Male	M10 Female

Isolation

Part #	From	To
MS034	¼"-28 UNF Male	¼"-28 UNF Female
MS093	Q/F Male	M8 Male

System connection

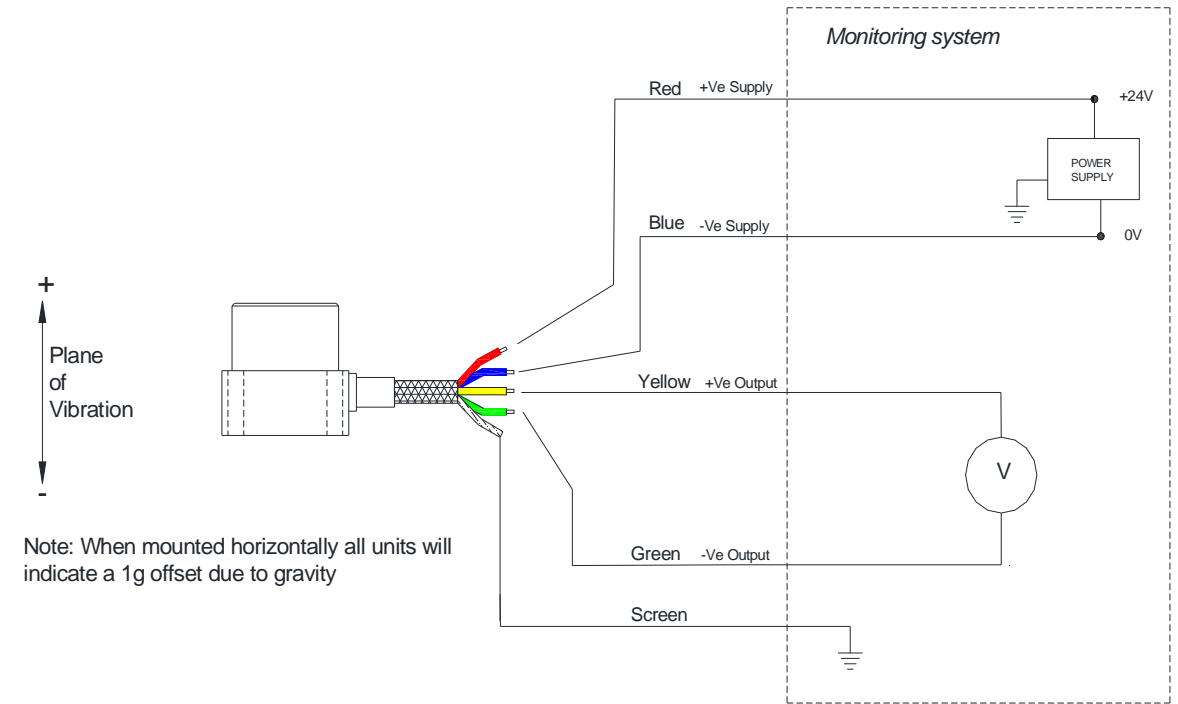

Dimensions of optional Sensors

